

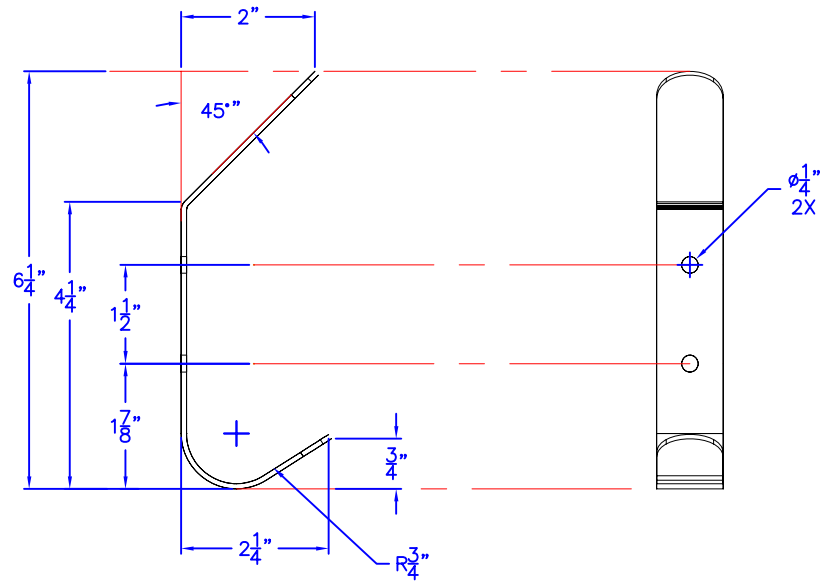

# Technical Data S-5035-XX

## EXPOSED MOUNT SHEET METAL HOOK



### FINISHES:

- SS SATIN STAINLESS
- BS BRIGHT STAINLESS
- (PC) POWDER COAT-SPECIFY COLOR

### Construction:

- 14 GAUGE TYPE 304 STAINLESS STEEL
- FORMED ONE PIECE CONSTRUCTION
- (2) 1/4" Ø MOUNTING HOLES
- FASTENERS ARE NOT INCLUDED

### Installation:

- USE HOOK AS TEMPLATE TO MARK HOLE LOCATIONS
- DRILL HOLES AND FASTEN TO WALL

CAUTION: HOOK IS ONLY AS STRONG AS THE ANCHORING DEVICES AND THE WALL ON WHICH IT IS MOUNTED TO.

### Guide Specification:

- ONE PIECE FORMED CONSTRUCTION SHEET METAL HOOK
- EXPOSED MOUNTING WITH (2) 1/4" HOLES
- 14 GAUGE TYPE 304 STAINLESS STEEL